

ZONING DISTRICTS

- R-1 LOW DENSITY RESIDENTIAL > 43,560 SQ. FT. LOT
- R-1α LOW DENSITY RESIDENTIAL > THREE LOTS PER ACRE
- R-2 MEDIUM DENSITY RESIDENTIAL > 5,500 SQ. FT. LOT
- R-3 MULTI-FAMILY RESIDENTIAL DISTRICT
- MH MANUFACTURED HOME DISTRICT
- C-1 COMMERCIAL DISTRICT
- I-1 INDUSTRIAL DISTRICT
- OP OPEN SPACE/PARKS DISTRICT
- PUBLIC/INSTITUTIONAL DISTRICT
- - - CITY LIMITS
- EXTRATERRITORIAL JURISDICTION

**PROPOSED
ZONING
DISTRICT**

LNIV
 TBPE FIRM NO. F-366
 8918 TESORO DRIVE
 SAN ANTONIO, TEXAS 78217

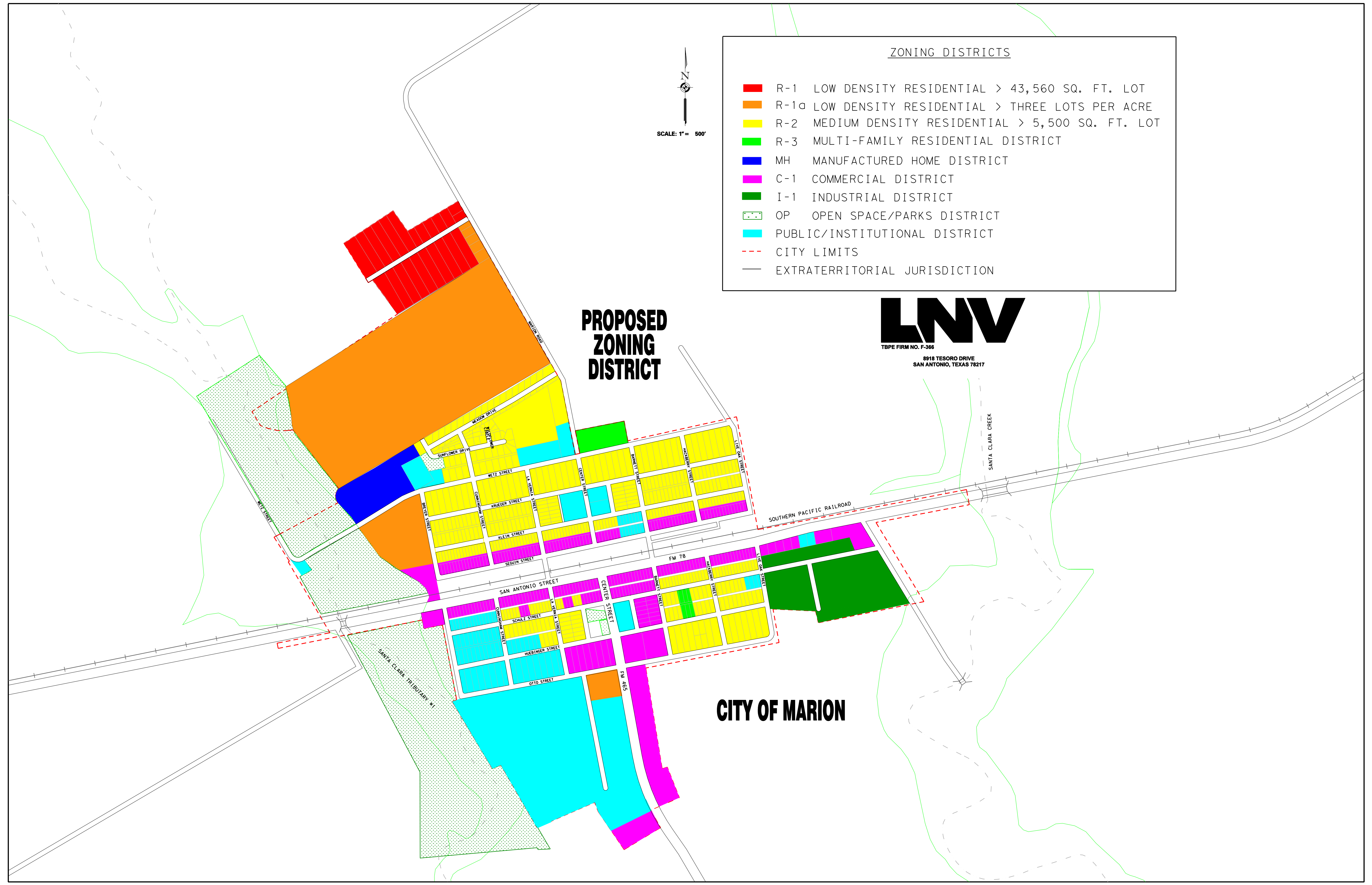

CITY OF MARION